

Wall-to-Wall Tie-Ins

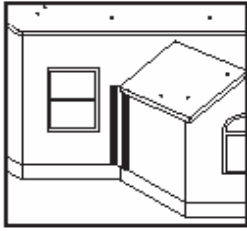

**Sheathing Sill
Splashback Areas**

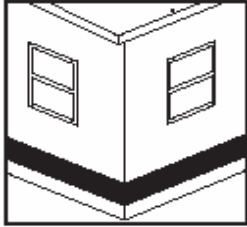

**Window and
Door Openings**

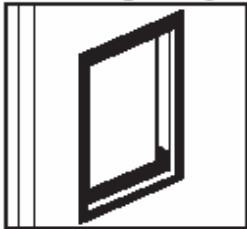

Corner Boards

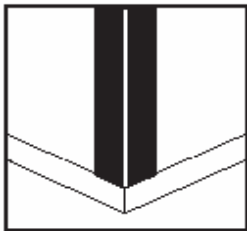

Sheathing Panel Seams

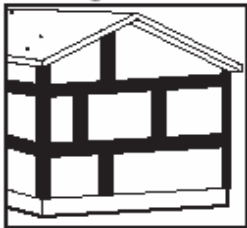

Cavity Walls



Dry-Flash[®] 25

Flashing / Air Barrier Tape

Dry-Flash[®] 25 is a flexible self-adhering rubberized asphalt sheet membrane with a reflective aluminum surface for use as a moisture or air barrier membrane in above grade construction of cavity walls, around window and door perimeters, and for joint sealing.

FEATURES AND BENEFITS

- Flexible SBS modified asphalt and aluminum surfacing provides excellent protection from moisture or air penetration.
- Treated release film for easier installation and handling.
- Self-adheres to foam board, concrete, block, gypsum or wood surfaces.
- Available in factory pre-cut widths of 4 inch, 6 inch, 9 inch, 12 inch, 18 inch or 36 inch rolls.
- Tested in accordance with ASTM D 1970 (for pliability), D 412, E 96, D 903, E 154

PRODUCT DATA *

	Thickness	Roll Size	Coverage per ctn.	Rolls per ctn.
4 inch	25 mils	4" x 100'	300 sq. ft.	9 rolls
6 inch	25 mils	6" x 100'	300 sq. ft.	6 rolls
9 inch	25 mils	9" x 100'	300 sq. ft.	4 rolls
12 inch	25 mils	12" x 100'	300 sq. ft.	3 rolls
18 inch	25 mils	18" x 100'	300 sq. ft.	2 rolls
36 inch	25 mils	36" x 100'	300 sq. ft.	1 roll

Fabricated Foam, LLC.

5210 East 64th Street
Indianapolis, IN 46220
Phone: 317-255-5157
Fax: 317-255-7166

* All values stated as nominal
Dry-Flash[®] 25 is a registered Trademark of Fabricated Foam, LLC.

Dry-Flash[®] 25 Application

Flashing / Air Barrier Tape

GENERAL APPLICATION

Apply **Dry-Flash[®] 25** to protect against moisture and air leaks in above grade construction applications such as cavity walls, around window and door perimeters and for sealing joints in corner boards, wall tie-ins and sheathing panels.

1. Cut **Dry-Flash[®] 25** to the proper length needed for application
2. Peel back a portion of the release film.
3. Position/align the strip. Remove the remaining release film and press into place making certain that all overlaps are done in shingle fashion for proper moisture drainage.

4. Mechanically fasten at all vertical terminations and other areas as needed, using a smooth shanked fastener.

5. Priming is generally not required for wood, OSB or gypsum sheathing, provided they are smooth, clean and dry. In any case where adhesion is found to be marginal and in all cases for concrete masonry, Dens Glass Gold* or Dens Glass Silver * prime with 3M Multi-purpose Adhesive Spray 77.

APPLICATION AROUND WINDOW AND DOOR OPENINGS

Use **Dry-Flash[®] 25** to seal the flanges at the sill and the jambs under the house wrap as shown in FIG 1. Start with a strip of **Dry-Flash[®] 25** at the sill. (1) Next, apply strips to seal the jamb flanges on both sides of the window and overlapping the sill strip (2) and (3). Finish with a strip of **Dry-Flash[®] 25** at the head flange of the window and overlapping the jamb strips. (4) Be sure to tape any over-cut in the house wrap.

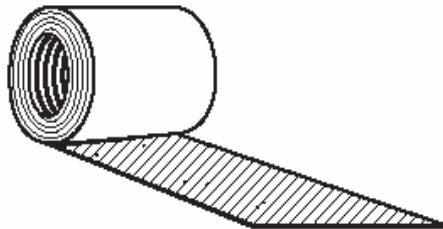
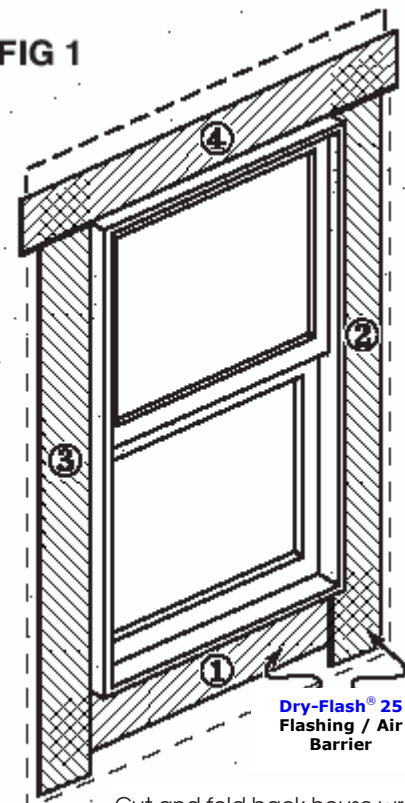

FIG 1



Cut and fold back house wrap
Before installing **Dry-Flash[®] 25**

* Dens Glass Gold and Dens Glass Silver are registered Trademarks of GP Gypsum Corporation.